

EBR-DIN-DALIG64

DIN rail DALI lighting control module

Overview

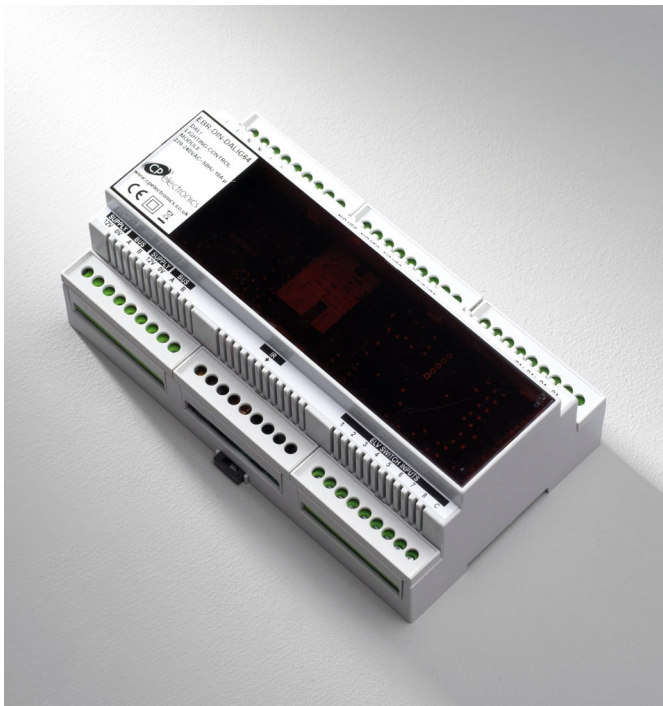

The EBR-DIN-DALIG64 is a Rapid lighting control module designed for controlling 64 addressable DALI devices such as fluorescent or LED lighting ballasts. There are two relays providing a switched live output and a third relay for emergency test. Additionally there is a volt free contact to control external devices.

This LCM also has a total of 8 switch inputs and 2 DALI connections.

Used in conjunction with our range of DALI presence detectors a single DALI cable can be run to digitally control all the lighting and power the sensors. This saves time and money on additional specialist cable. It is ideal for chilled beam, continuous run lighting, and core areas.

Please speak to our technical team for further information.

Features

Front features

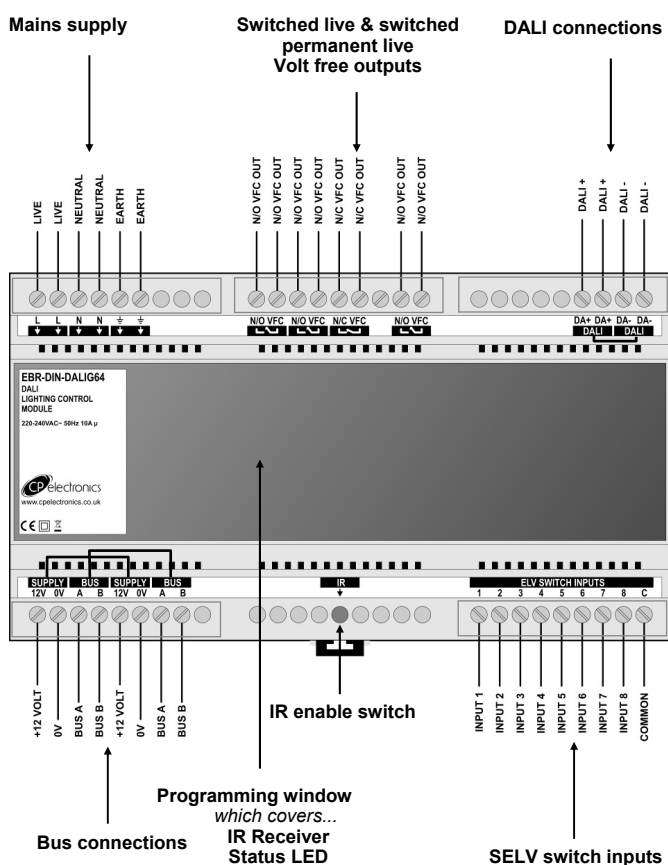

Mains connections

- Live, Earth, Neutral.

SELV switch inputs

- 8 SELV switch inputs.

Volt free outputs

- 3 x normally open 10A 230VAC rated Voltage free relays. Used to switch external peripherals, such as HVAC and BMS systems.
- 1 x normally closed 6A 230VAC rated Voltage free relay. Suitable for emergency testing.

Communication ports

- 1 x power and Rapid network bus port
- 1 x DALI port

Removable Terminals (plug & socket)

Hardware build 1.4 or later versions are upgraded with removable terminals throughout for easy wiring or product replacement onsite.

Removable memory feature

Hardware build 1.4 or later versions are upgraded with the removable memory feature that allows settings to be easily transferred to a replacement unit without re-programming.

System wiring example

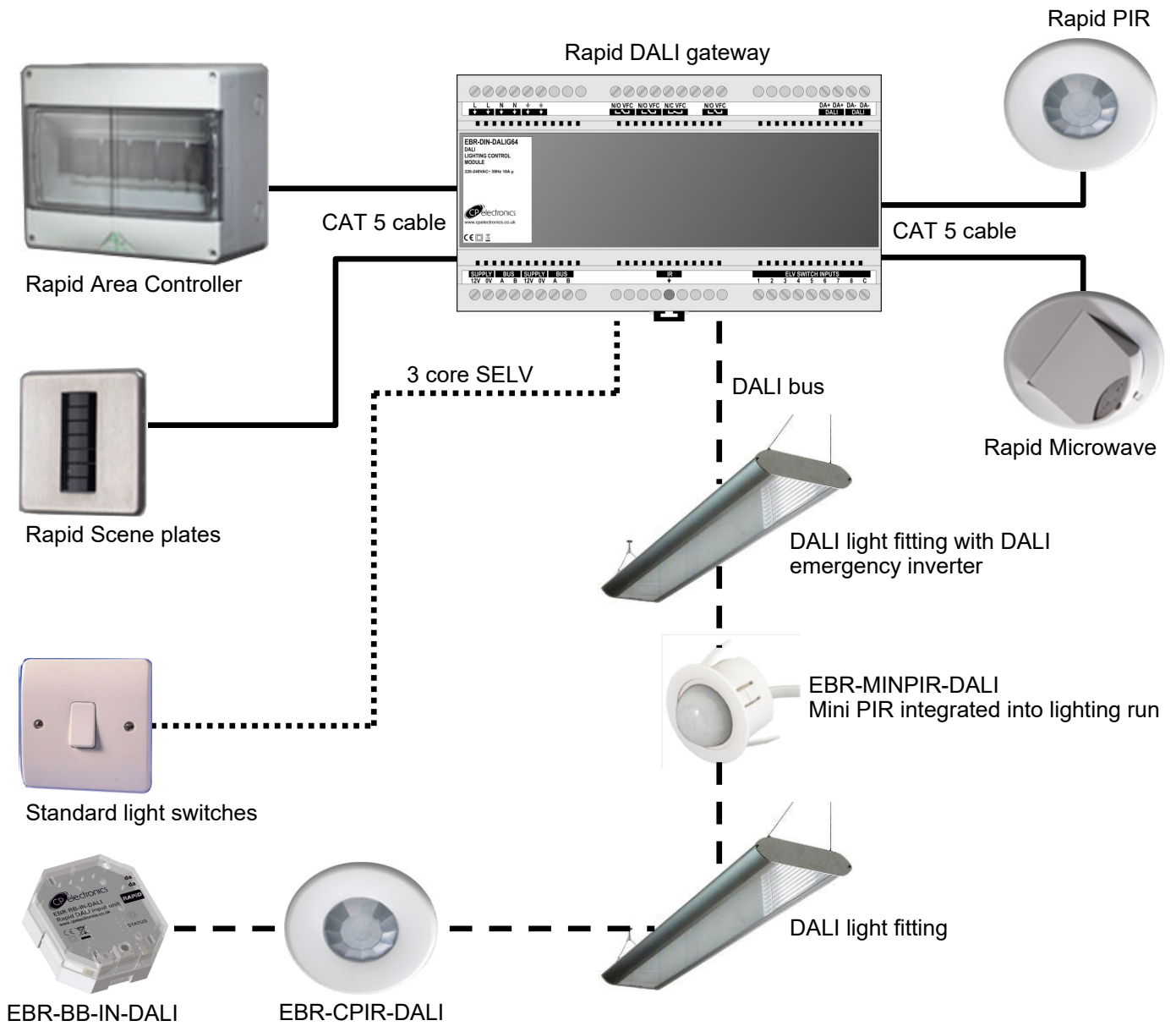

DALI bus loading

Devices (detectors / input units) and ballast combinations for 200mA supply.

This assumes that the sensor LEDs are all on, and the sensor is receiving IR communication.

- 4 devices and up to 64 ballasts
- 5 devices and up to 55 ballasts
- 6 devices and up to 44 ballasts
- 7 devices and up to 33 ballasts
- 8 devices and up to 22 ballasts
- 9 devices and up to 12 ballasts
- 10 devices and up to 2 ballasts

In most realistic scenarios, only one LED is on at a time and only one detector is receiving IR; guidance changes to.

- 10 devices up to 64 ballasts
- 11 devices up to 60 ballasts
- 12 devices up to 55 ballasts
- 13 devices up to 50 ballasts
- 14 devices up to 48 ballasts
- 15 devices up to 44 ballasts

Addressing limits of DG64

- 5 input units of 7 channels each
- 10 detectors

This page intentionally left blank

Technical data

Dimensions	See diagrams opposite	
Weight	0.40kg	
Supply Voltage	220 - 240VAC	
Frequency	50Hz	
Relay rating	Normally open relays	10A
	Normally closed relay	6A
	Volt free output	10A
Terminal Capacity	2.5mm ²	
Power consumption	On 2930mW, Off 2120mW	
DALI Voltage	16VDC via DALI	
DALI Output Current	250mA (maximum)	
DALI bus	Cannot be considered as SELV since DALI, ballasts only offer basic insulation, therefore all devices on the DALI bus must be wired as if carrying mains potential.	
Temperature	-10°C to 35°C	
Humidity	5 to 95% non-condensing	
Material (casing)	Flame retardant ABS and PC/ABS	
Classifications	Insulation	Class II
	Purpose	Operating control
	Construction	Incorporated control
	Type of action	Type 1.B action micro disconnection
	Software class	Class A
	Pollution	Degree 2

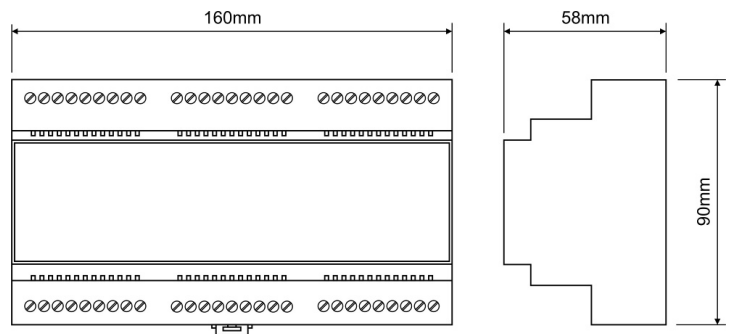

Compliance



For further compliance information visit
www.cpelectronics.co.uk/compliance

Part numbers

	Part number	Description
Control module	EBR-DIN-DALIG64	DIN rail DALI lighting control module
Accessories	UNLCDHS	Universal LCD programming handset



FM 45789

EMS 534520

OHS 642036



CP Electronics - a business unit of
 Legrand Electric Limited
 Brent Crescent, London NW10 7XR UK
 Tel: +44 (0)333 900 0671
 Fax: +44 (0)333 900 0674

A brand of **legrand**[®]
www.cpelectronics.co.uk
enquiry@cpelectronics.co.uk